

STEP 4: SYSTEM SETTINGS

By default, a Sooloos Ensemble or Source acts as the System Core. In this system, you must set the Control 10 to act as the System Core, by following the steps below.

- 1 Tap Settings Icon in the upper right corner of the Cover Browser and tap "System Settings"
- 2 On the Settings page, tap "Devices" (located in the lower left-hand corner) and then tap the "Confirm" button
- 3 On the Devices page, tap "Control 10"
- 4 On the Control 10 Device Configuration page, check the box next to "System Core"
- 5 Tap "Apply Settings"

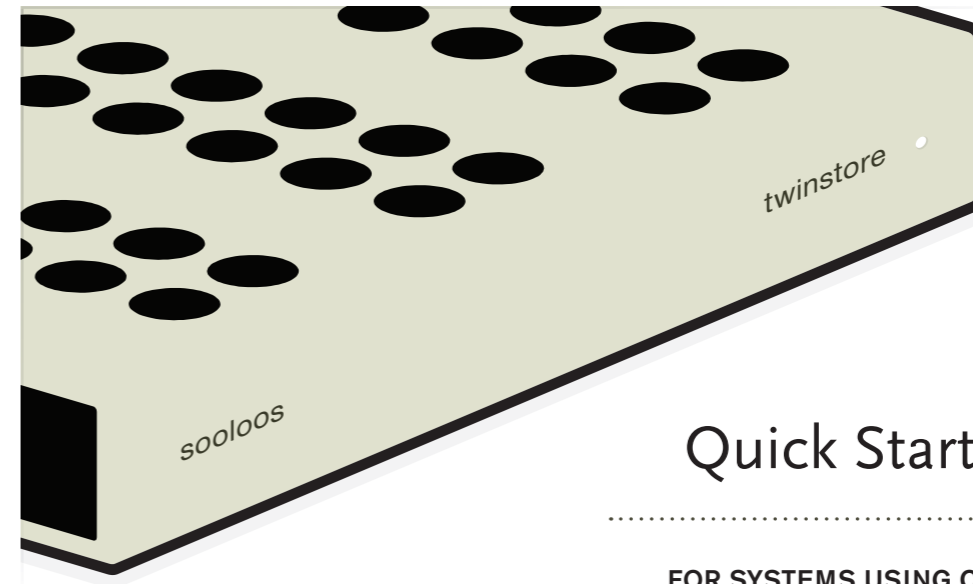
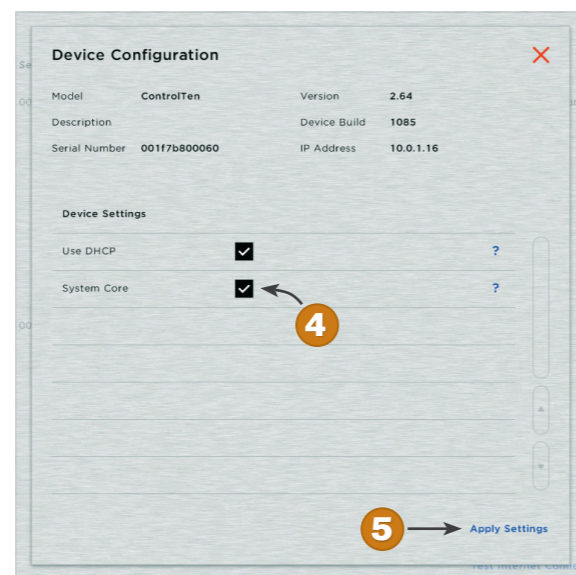

Quick Start Guide

FOR SYSTEMS USING CONTROL 10 AS A PRIMARY SOURCE COMPONENT

(Control 10 + Twinstore)

STEP 1: AUDIO CONNECTIONS

- 1 Your Control 10 features a S/PDIF digital audio output. This can be connected to an S/PDIF input on your audio system, or on Meridian Digital Active loudspeakers. The Control 10 also includes a SpeakerLink output, which can be connected to Meridian Digital Active loudspeakers.
 - A. S/PDIF digital audio output
 - B. Meridian SpeakerLink audio output
 - C. Meridian Comms (for integrating your Control 10 with a Meridian system)
 - D. Meridian trigger and analogue inputs (included for future use)

As a precaution, please lower the volume and/or power down any external audio components before making new audio connections.

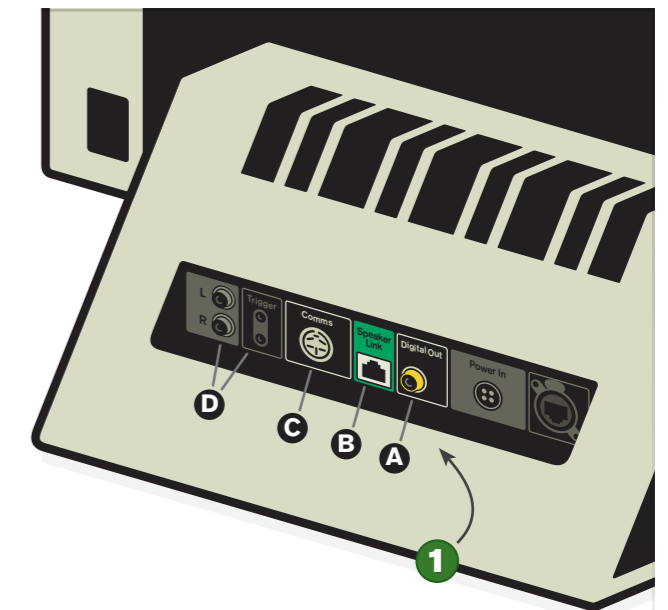

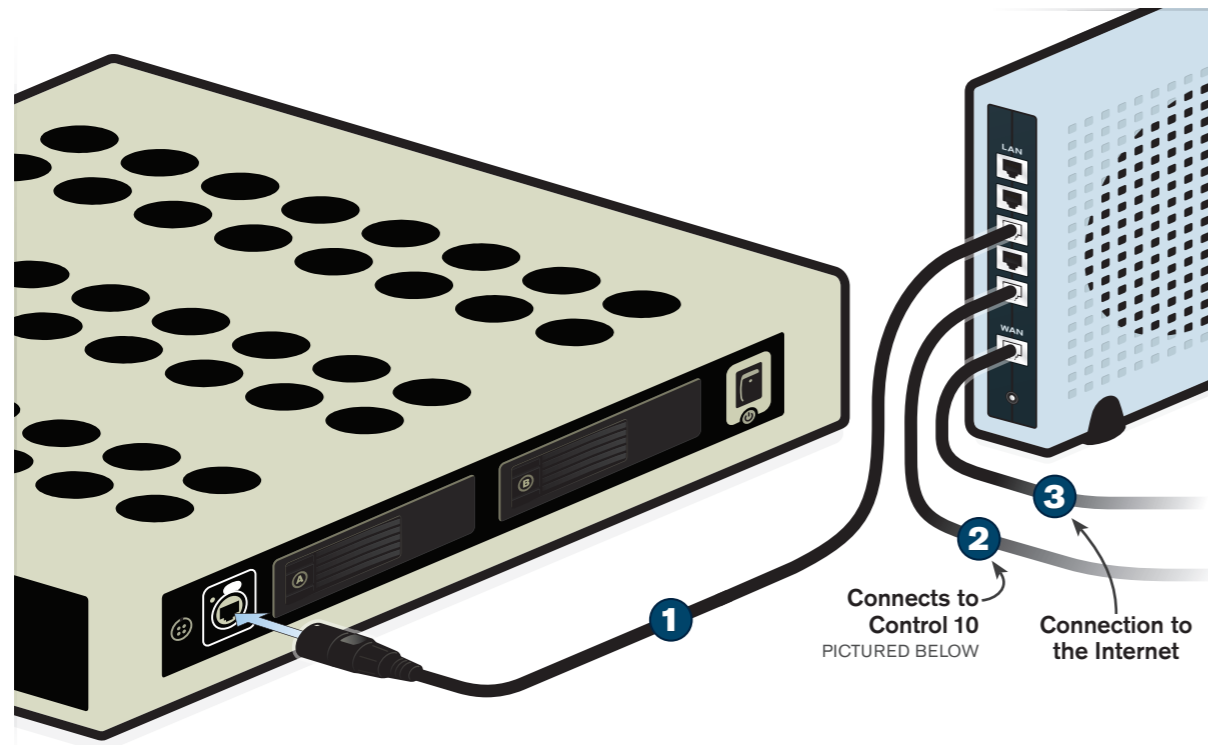

1 Connects to Control 10 PICTURED BELOW
2 Connection to the Internet
3

STEP 2: NETWORK CONNECTIONS

- 1 Attach the Twinstore's network port to a LAN port on your router. You can use the Neutrik Ethercon connector (supplied) with an Ethernet cable of the appropriate length (not supplied.)
 - 2 Attach the Control's network port to a LAN port on your router. You can use an additional Neutrik Ethercon connector with your own Ethernet cable here as well.
 - 3 Make sure the WAN/Internet port of this router connects to the rest of your network, or to your Cable/DSL modem.
- ! Depending on the make and model of your router, crossover Ethernet cable(s) may be required to make valid connections to your Ensemble and Control components.



2 Connect to a LAN port on your network router PICTURED ABOVE

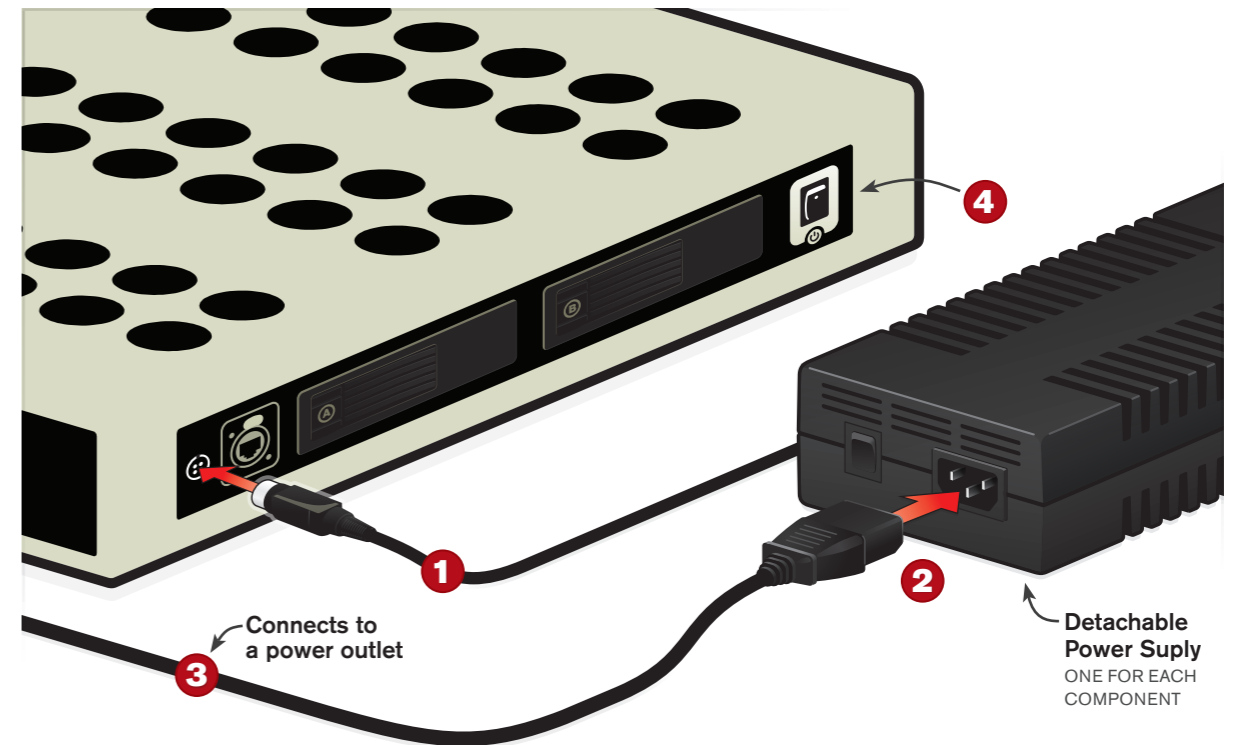

1 Connects to a power outlet
2 Detachable Power Supply ONE FOR EACH COMPONENT
3
4

STEP 3: POWER CONNECTIONS

- 1 Connect the power supplies (provided) to the rear of each Ensemble, and Control device.
 - 2 Connect an IEC power cable to each supply.
 - 3 Plug each power cable into a surge-protected power strip.
 - 4 Power-on each component by rocking its rear-panel power switch.
- ! All external power supplies are auto-sensing, and use universal voltage power supplies.
- ! Rackmount devices with internal power supplies are not auto sensing and must be set to the proper local voltage...

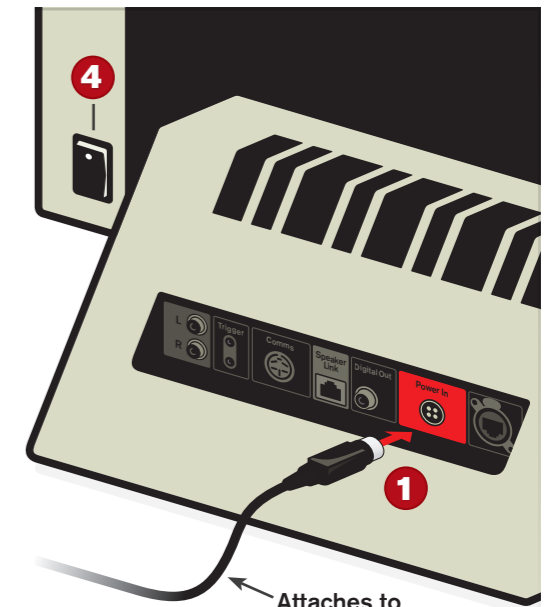

1 Attaches to a power supply PICTURED ABOVE
4

115 AC 115V NORTH AMERICA 230 AC 230V EUROPE, ASIA